

# THE BRICKMAKERS

## Technical Specifications for Artists & Promoters



01603-441118



brickmakerslive@gmail.com  
[www.thebrickmakers.com](http://www.thebrickmakers.com)



**496 Spowston Road**  
Norwich, Norfolk, NR3 4DY.

**Tech Contact:**

Technical Manager - Charley South (brickmakerslive@gmail.com)

**Venue Capacity**

Standing 275

Limited Seating 25

**Covid Setup**

Tables and chairs throughout whole building.

Band Room – 52 show (stage view)

Snug (Screen View) 32

**Power**

Stage and lighting on separate phases.

**Sound**

4 x HK Audio IL 12.1

2 x HK Audio IL218 Subs

1x LA Audio DLX 260 DSP system management processor

1x LAB GRUPPEN FP9000

**Monitoring**

3 x HK Audio 112M

1 x HK Audio PRO15 Drum Fill

1 x HK Audio PRO 15 D

1x Crest Audio Pro 8200

2 x QSC RMX 1450

**IEM**

We do not provide IEM systems but there is capability for 7 IEM mixes

**FOH – Front Of House**

Allen & Heath QU-24

**Multicore**

Vann Damme 24/4

## **Microphones:**

5 x Shure SM58  
2 x Electrovoice ND-35  
5 x Audio Technica AT2010  
4 x Shure SM57  
1 x AKG CS1000  
1 x AKG D112  
1 x Shure PG52  
3 x Shure PG56  
4 x AKG P4  
8 x Behringer DI100 Ultra-DI Active DI Box

## **Lighting**

10 x Chauvet PAR64 LED Par56  
2 x Stairville Mini Moving Heads  
2 x Stairville Mini Scanners  
1 x Martin Magnum Hazer  
Das light Gold lighting controller software

## **AV and film**

1 x Roland V-40HD Video Switcher  
3 x Panasonic HC VX980 4K Static cameras  
1 x Panasonic HC VX980 4K motorised camera  
1 x motorised projector screen (centre stage)  
1 x portable projector screen  
HDMI from FOH

## **Stage Area**

Two tierd stage.  
Lower Level 1 - 7m (W) x 1.8m (D) x 60cm (H)  
Upper Level 2 - 7m (W) x 2m (D) x 1m (H)  
No stage barrier

## **Accessibility**

If any artist or member of the party has any access requirements, please contact Emma (brickmakerslive@gmail.com)

## **Dressing Rooms**

1 x changing room (Seats 5) in outside static van in lockable area & outside space  
Larger dressing area for bigger bands available (Prior arrangement required)  
No showering facilities on site / No artist toilet facilities backstage

## **Load In**

Usual load in is 3pm-4pm,

Standard soundcheck is 6pm

Earlier load in time/soundcheck time can be arranged upon request

Load in from the front of building, through double doors under smoking shelter.

**Please note: During Covid restrictions, load in is via the gate to the left of double doors straight onto the back of stage.**

## **Weekday Performance Times**

Start: 7.30pm

Curfew: 10.30pm

## **Weekend Performance Times**

Start: 8pm

Curfew: 11.30pm

## **Parking**

There are car parking spaces for 50 cars in the venue car park.

## **Tour Busses**

There is room to park a tour bus at the front and the back of the building. There is a 3 phase power outlet available for tour busses.

## **Available Backline**

1 x Pearl Export Drum kit (6 piece)

1 x Pair of Istanbul Hi Hats

1 x Zildjian Heavy Ride Cymbal

Various Zildjian, Paiste, Meinl crash cymbals

1 x Peavy TNT 100W Bass Amp

1 x Behringer 8x10 BB810 Bass Cab

1 x Ibanez Toneblaster 100H

1 x Marshall MG100HGFX 100W

1 x Ibanez TB412 Toneblaster Cab

1 x Marshall 4x12 Cab

## **Accessibility**

If any artist or member of the party has any access requirements, please contact Emma (brickmakerslive@gmail.com) or Charley South (charley@brickiesradio.com)

# SPROWSTON ROAD

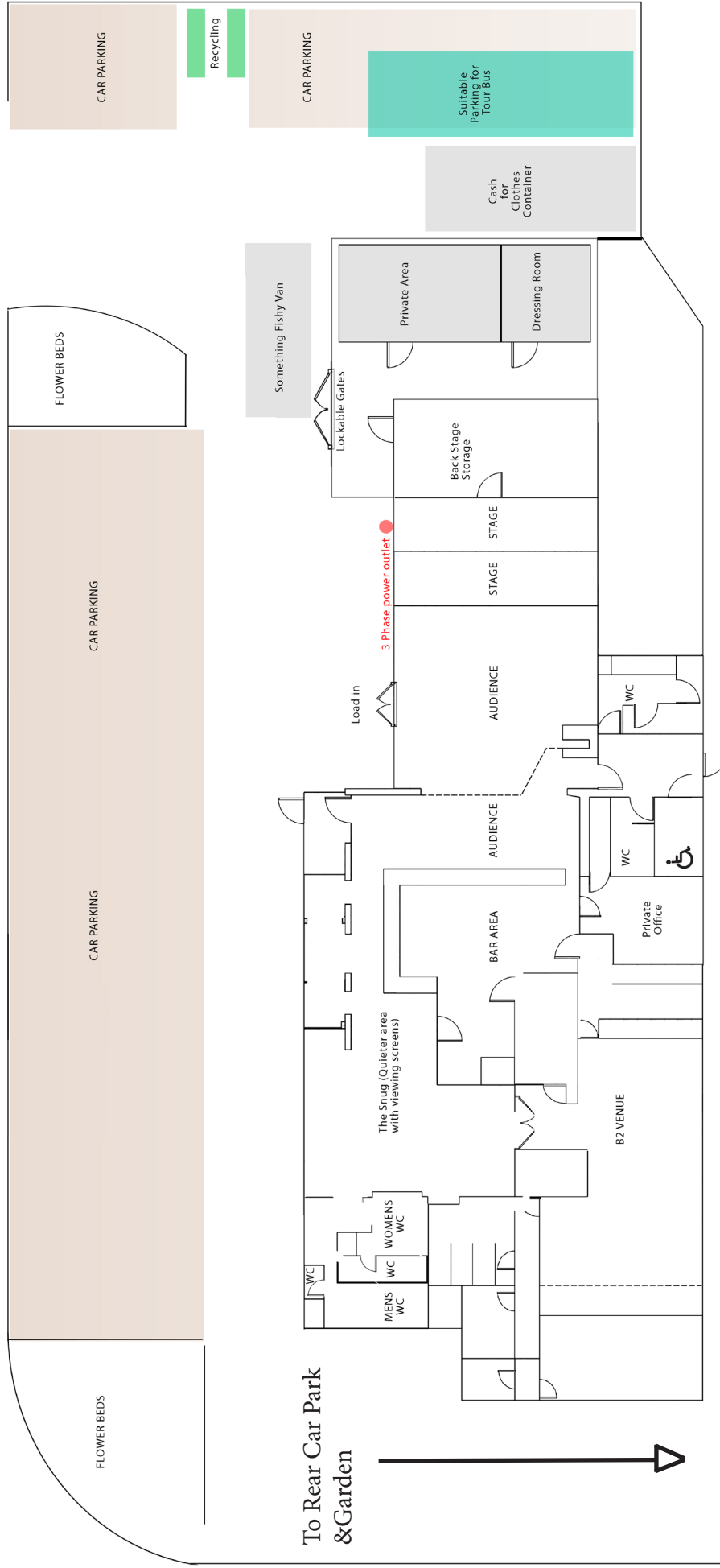

To Rear Car Park  
& Garden